

# Essential Skills Wales

## Essential Application of Number Skills (EAoNS)

### Level 2 Controlled Task

#### Candidate Pack

#### Staycation

Version 2.3

#### Sample (Set A)

#### Instructions

- Fill in the candidate information boxes below.
- Complete **all** parts of the task.
- Sign and date the declaration on the next page when you have completed the task.

Candidate name:
Candidate number:
Date registered for EAoNS:
Unique Learner Number (ULN) ( <i>if applicable</i> ):
Centre name <i>or</i> number:

You have up to **5 hours in total** to complete this controlled task.

The total time can be split over a number of sessions.

Details of when each session started and ended **must** be recorded below:

Date controlled task <b>started</b> :							
Date controlled task <b>completed</b> ( <i>no more than eight weeks later</i> ):							
Session 1	Session 2	Session 3	Session 4	Session 5	Session 6	Session 7	Session 8
	<i>Date</i>	<i>Date</i>	<i>Date</i>	<i>Date</i>	<i>Date</i>	<i>Date</i>	<i>Date</i>
<i>Duration</i>	<i>Duration</i>	<i>Duration</i>	<i>Duration</i>	<i>Duration</i>	<i>Duration</i>	<i>Duration</i>	<i>Duration</i>
<b>Total time spent:</b>				Supervisor signature:			

If more than eight sessions are required, any further dates/durations should be recorded on a separate sheet.

Produced jointly by the four Essential Skills awarding bodies:

Agored Cymru  
City & Guilds  
Pearson  
WJEC

**This task pack contains a scenario, a set of instructions and source material.**

- Read the scenario, instructions and source material carefully before you start.
- You will be supervised throughout your time working on this task.
- You can use most of the equipment normally available to you in a real-life situation, including internet access.
- All work submitted must be **entirely** your own. You are not allowed any help with the skills that are being assessed through this controlled task.
- Hand in all of your work at the end of **each** session. You are not allowed to take any task materials away with you, or have access to these between sessions.
- Sign and date the declaration below when you have completed the task.

**Candidate declaration**

I confirm that this controlled task is entirely my own work and it was completed during the supervised sessions stated on the front page.

Candidate signature: \_\_\_\_\_ Date: \_\_\_\_\_

## Task Instructions: Staycation

### What you need to find out

#### Scenario

You work for a company that advertises holiday cottages for rent. The owner of a new one bedroom cottage in the Brecon Beacons wants to rent it out to holidaymakers. She wants to install a ramp to the front step of the cottage to make it accessible for wheelchair users.

The aims of this task are to:

- recommend a suitable weekly rent for the new cottage, for low season, mid-season and high season
- work out how much a customer should pay for rent and electricity for a two week stay in the cottage
- make recommendations about the slope and position of the ramp.

Use the sources provided.

### What you need to do

#### Part 1

Read through the task and source materials.

Make a plan to show how you will do this task.

Show your plan as a list, a table, a spider diagram or a flow chart.

You must include:

- the information you will use from the source materials
- the calculations you will do
- the reason(s) for your choice of **at least one** of your calculations
- how you will present your findings for Part 2 and Part 3.

(Total for Part 1: 3 marks)

In **Part 2 and Part 3**, you must:

- show all the calculations you do. If you use a calculator, make a note of what you put into the calculator. If you use a spreadsheet, make a note of the numbers and the formulas you use.
- give your answers to a suitable level of accuracy.

Remember to check your calculations.

## Part 2

You need to recommend a suitable weekly rent for the new cottage for low season, mid-season and high season.

You must:

- compare the average weekly low season rent for two groups of local cottages:
  - cottages that are accessible to wheelchair users
  - cottages that are not accessible to wheelchair users
- make **at least one** comment on your findings
- recommend a suitable weekly low season rent for the new cottage
- calculate a suitable weekly rent for the mid-season and the high season for the new cottage.

A customer wants to stay in the new cottage for 2 weeks from 15 May to 28 May.

You must:

- calculate the total cost of rent and electricity for the customer
- present your findings in a suitable way (complex table, diagram, line graph, comparative/component bar chart or pie chart).

Remember to check your calculations.

(Total for Part 2: 12 marks)

## Part 3

The owner of the new cottage wants to install a concrete ramp for the front step of the cottage. You need to make recommendations about the slope and position of the ramp.

You must:

- calculate the ratio of the slope of the proposed ramp
- do a calculation to decide how to change the proposed ramp so that it meets regulations
- calculate the volume of concrete needed to make the ramp
- make **at least two** comments about the proposed ramp including:
  - how the slope should be changed to meet regulations
  - where the ramp should be built, and why you recommend that position.
- present your findings in a suitable way (table, diagram, line graph, bar chart or pie chart). Use a different method to the one you used in Part 2.

Remember to check your calculations.

(Total for Part 3: 12 marks)

## Sources you should use

### Source 1

- Table – one bedroom cottages for rent in the Brecon Beacons

### Source 2

- Information – mid-season and high season rent for the new cottage

### Source 3

- Table – seasons for rental of the new cottage

### Source 4

- Table – electricity costs for the new cottage

### Source 5

- Chart – average temperature and number of rainy days in the Brecon Beacons

### Source 6

- Diagram – ground plan of the new cottage

### Source 7

- Diagram – proposed ramp to the front step of the new cottage

### Source 8

- Formula – volume of a prism

**Source 1 Table – one bedroom cottages for rent in the Brecon Beacons**

<b>Cottage</b>	<b>Weekly rent (low season)</b>	<b>Accessible to wheelchair users</b>
Cliff Top Cottage, Llandovery	£644	Yes
High Cottage, Hay-on-Wye	£850	Yes
St David's Cottage, Llandovery	£350	No
Ann's Cottage, Abergavenny	£355	No
The Oakleaf, Abergavenny	£496	No
April Cottage, Llandeilo	£450	No
Barn Hill Cottage, Llandovery	£650	Yes
Grange Cottage, Hay-on-Wye	£400	No
Strawberry Wood Cottage, Hay-on-Wye	£350	No
No 6 Cottage, Llandovery	£495	No
Pink Cottage, Llandovery	£750	Yes
St Michael's Cottage, Sennybridge	£650	No
Shire Farm Cottage, Sennybridge	£350	No
The Woods, Abergavenny	£500	Yes
Lower Hill Cottage, Llandovery	£495	No
May Cottage, Talgarth	£380	No
Raspberry Wood Cottage, Abergavenny	£349	No
Eaters Edge Cottage, Llandovery	£750	Yes
Rita's Cottage, Abergavenny	£350	No
The Edge Cottage, Llandovery	£620	Yes
Pine Wood Cottage, Llandovery	£549	Yes
Village Edge Cottage, Llandeilo	£590	Yes
The Byre Cottage, Crickhowell	£320	No

## Source 2 Information – mid-season and high season rent for the new cottage

### Mid-season and high season rent for the new cottage

The weekly rent in mid-season is 23% more than the weekly rent in low season.

The weekly rent in high season is 28% more than the weekly rent in low season.

## Source 3 Table – seasons for rental of the new cottage

Seasons for cottage rental	
Date to and from	Season
2 Jan – 12 Feb	Low season
13 Feb – 19 Feb	Mid season
20 Feb – 26 March	Low season
27 March – 2 April	High season
3 April – 9 April	High season
10 April – 30 April	Low season
1 May – 7 May	High season
8 May – 21 May	Mid season
22 May – 28 May	High season
29 May – 16 July	High season
17 July – 3 Sept	High season
4 Sept – 24 Sept	High season
25 Sept – 22 Oct	Mid season
23 Oct – 29 Oct	High season
30 Oct – 17 Dec	Low season
18 Dec – 1 Jan	High season

**Note:** The rent for each week of your stay depends on the season in which the week falls.

## Source 4 Table – electricity costs for the new cottage

The cost of electricity is based on the monthly average temperature.

Monthly average temperature (°C)	Cost of electricity (£ per week)
under 5	45
5 - 10	40
11 - 15	35
16 or above	30



Source 5 Chart – average temperature and number of rainy days in the Brecon Beacons

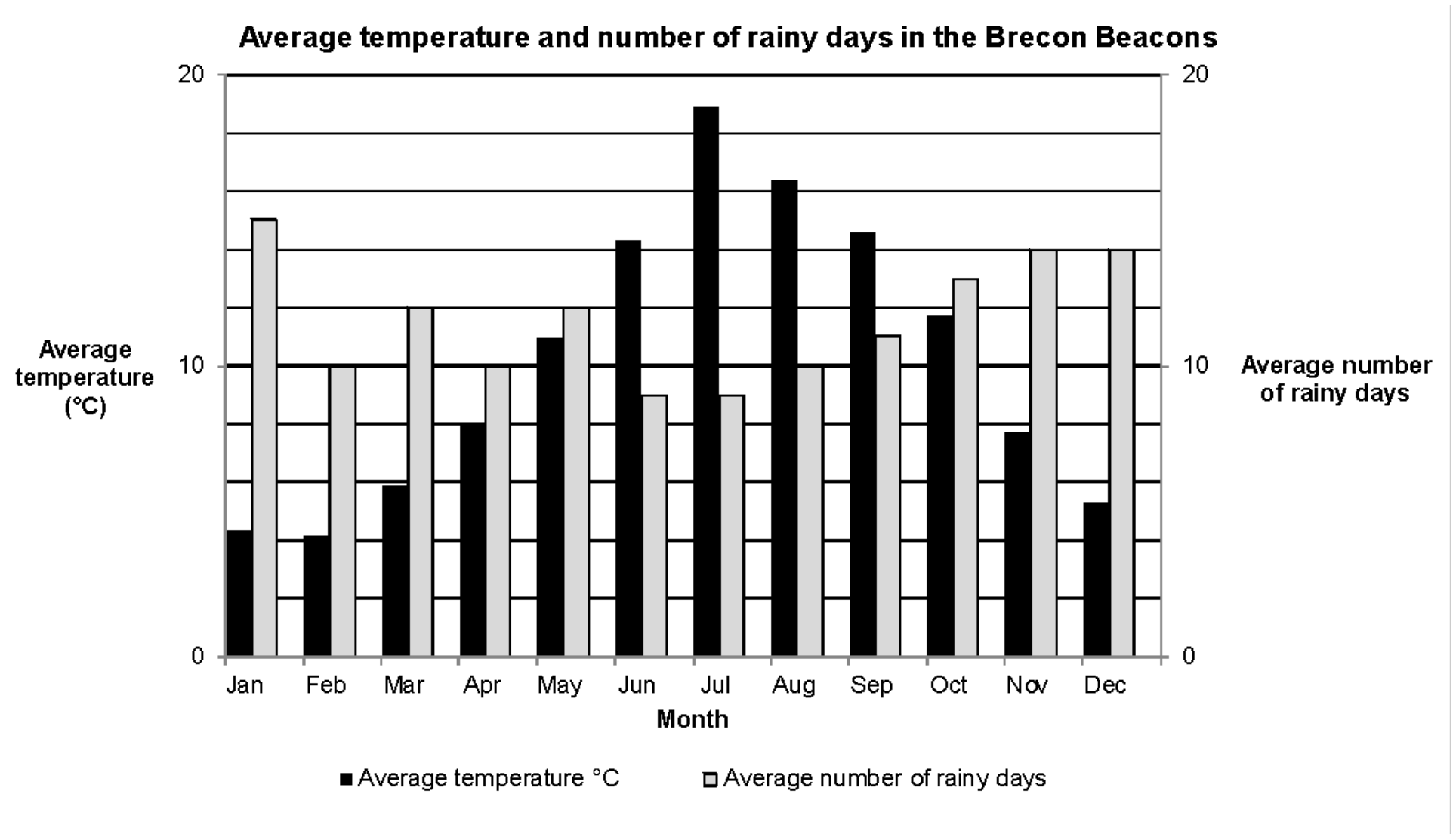

Source 6 Diagram – ground plan of the new cottage

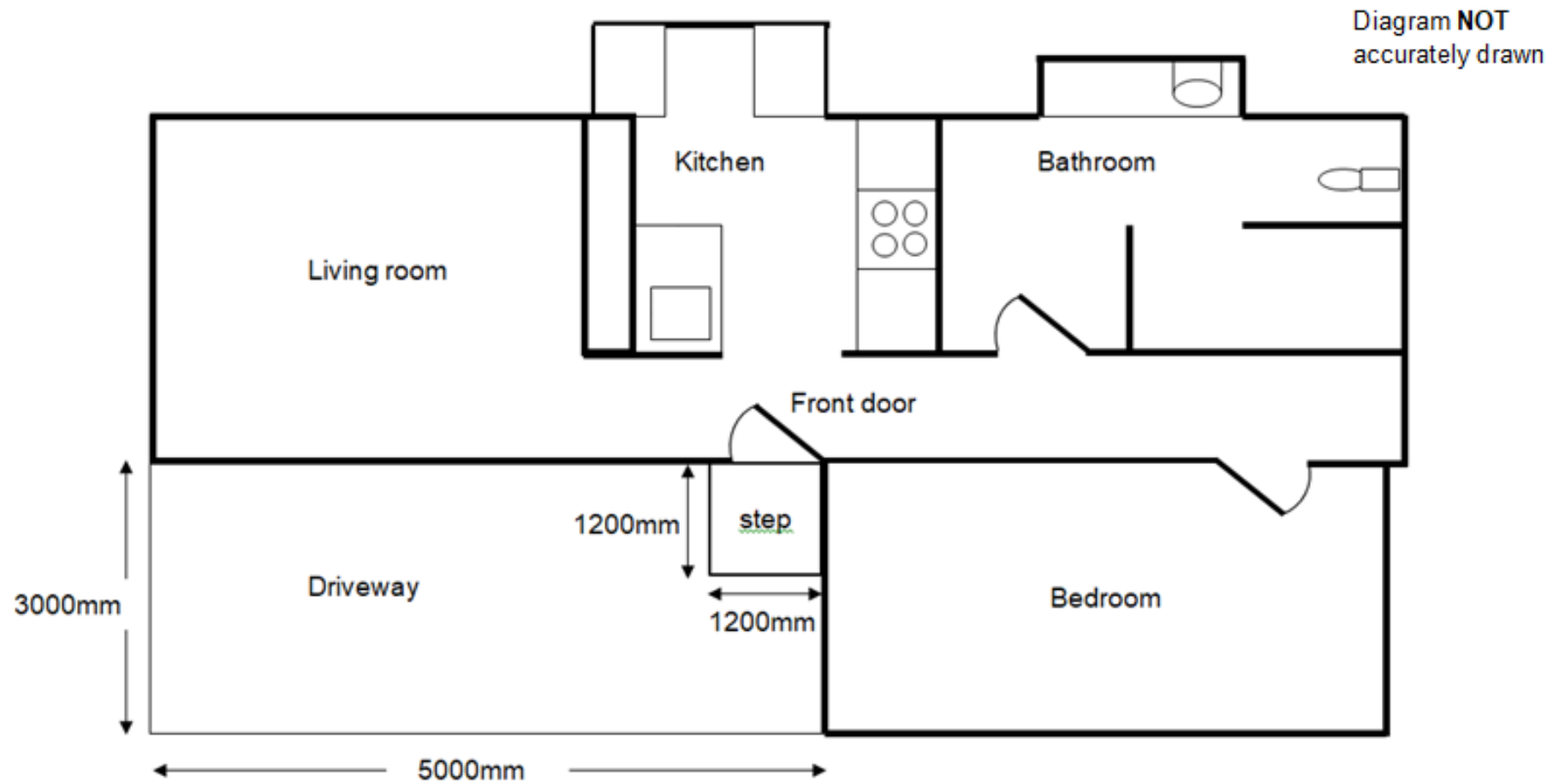

## Source 7 Diagram – proposed ramp to the front step of the new cottage

### Side view of the proposed ramp to the front step of the new cottage

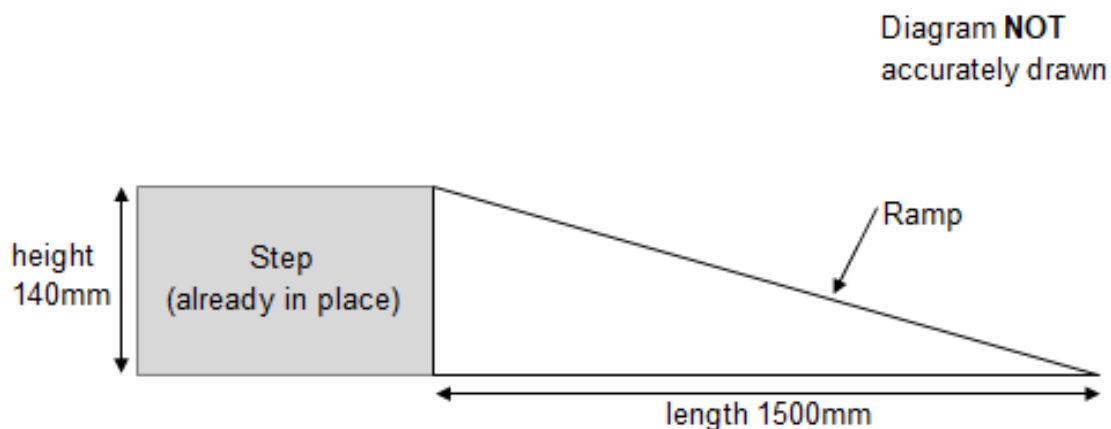

### Notes

The slope of a ramp is the ratio of the height to the length.

To meet safety regulations, the slope must have a ratio between 1 : 12 and 1 : 20

A slope steeper than 1 : 12 is not safe for wheelchair users.

The width of the ramp will be equal to the width of the step.

## Source 8 Formula – volume of a prism

$$V = \frac{lwh}{2}$$

where:

V is the volume of a prism in cubic metres

l is the length in metres

w is the width in metres

h is the height in metres